

Microsoft

MS-102 Exam

**Microsoft 365 Administrator Exam
Questions & Answers
Demo**

Version: 5.0

Question: 1

HOTSPOT

You need to configure a conditional access policy to meet the compliance requirements.

You add Exchange Online as a cloud app.

Which two additional settings should you configure in Policy1? To answer, select the appropriate options in the answer area.

NOTE: Each correct selection is worth one point.

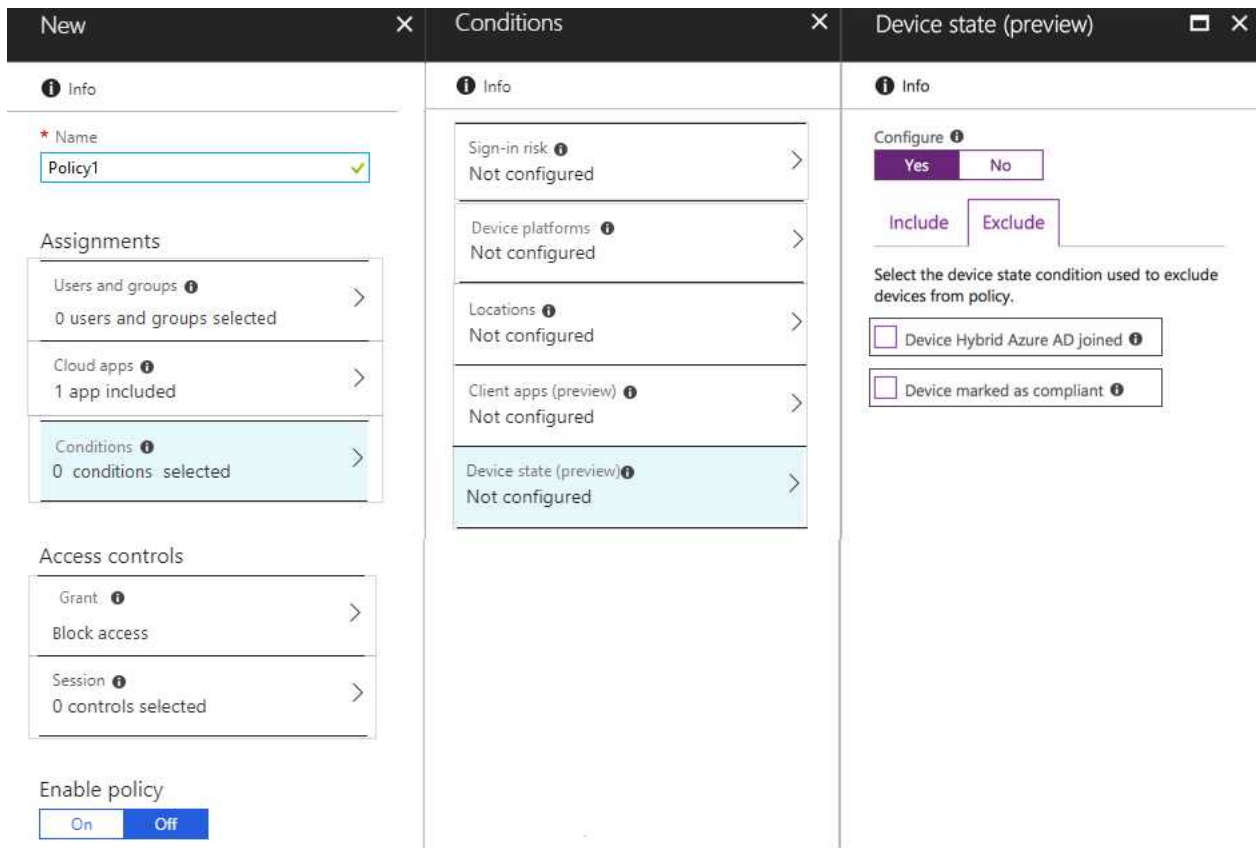

Answer:

Explanation:

Suggested Answer:

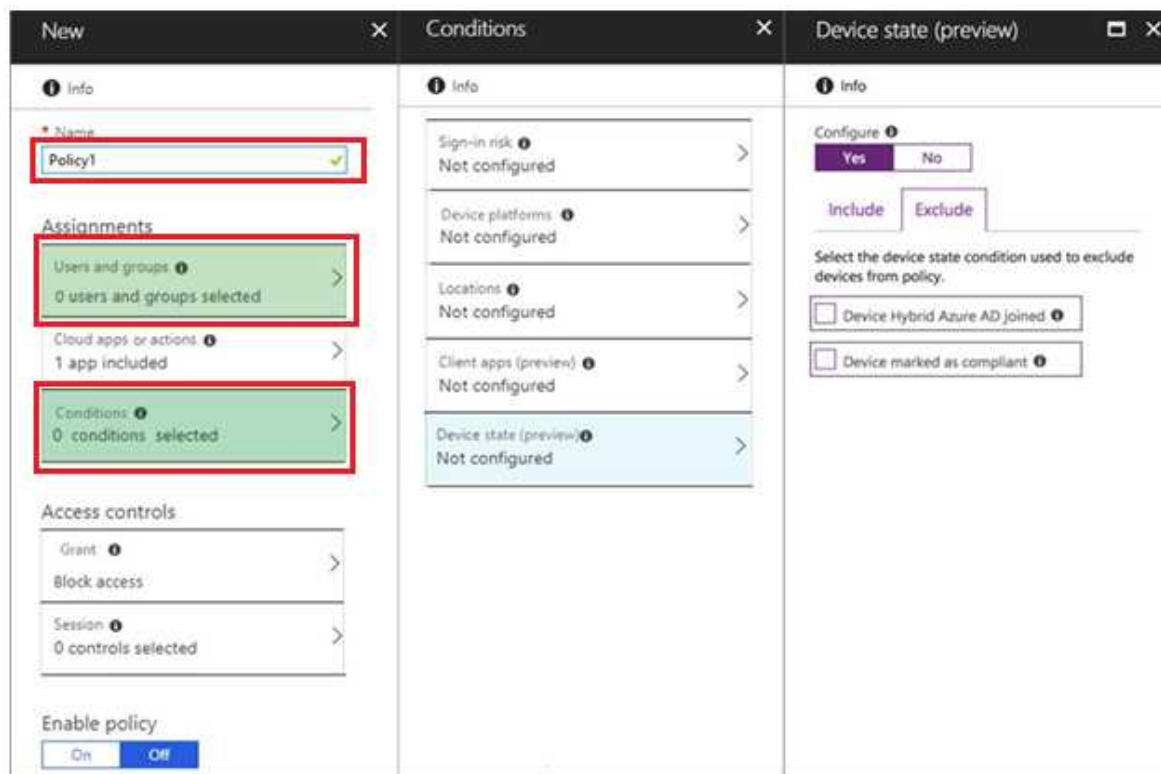

Reference:

<https://docs.microsoft.com/en-us/intune/create-conditional-access-intune>

Question: 2

On which server should you install the Azure ATP sensor?

- A. Server 1
- B. Server 2
- C. Server 3
- D. Server 4
- E. Server 5

Answer: A

Explanation:

Reference:

<https://docs.microsoft.com/en-us/azure-advanced-threat-protection/atp-capacity-planning>

However, if the case study had required that the DCs can't have any s/w installed, then the answer would have been a standalone sensor on Server2. In this scenario, the given answer is correct. BTW, ATP now known as Defender for Identity.

Question: 3

You need to meet the compliance requirements for the Windows 10 devices.

What should you create from the Intune admin center?

- A. a device compliance policy
- B. a device configuration profile
- C. an application policy
- D. an app configuration policy

Answer: C

Explanation:

Question: 4

HOTSPOT

You need to meet the Intune requirements for the Windows 10 devices.

What should you do? To answer, select the appropriate options in the answer area.

NOTE: Each correct selection is worth one point.

Settings to configure in Azure AD:

Device settings
Mobility (MDM and MAM)
Organizational relationships
User settings

Settings to configure in Intune:

Device compliance
Device configuration
Device enrollment
Mobile Device Management Authority

Answer:

Explanation:

Settings to configure in Azure AD:

Device settings
Mobility (MDM and MAM)
Organizational relationships
User settings

Settings to configure in Intune:

Device compliance
Device configuration
Device enrollment
Mobile Device Management Authority

Reference:

<https://docs.microsoft.com/en-us/intune/windows-enroll>

Question: 5

HOTSPOT

As of March, how long will the computers in each office remain supported by Microsoft? To answer, select the appropriate options in the answer area.

NOTE: Each correct selection is worth one point.

Seattle:

	▼
6 months	
18 months	
24 months	
30 months	
5 years	

New York:

	▼
6 months	
18 months	
24 months	
30 months	
5 years	

Explanation:

_____ **Answer:** _____

Seattle:

▼
6 months
18 months
24 months
30 months
5 years

New York:

▼
6 months
18 months
24 months
30 months
5 years

<https://support.microsoft.com/en-gb/help/13853/windows-lifecycle-fact-sheet> March Feature Updates: Serviced for 18 months from release date September Feature Updates: Serviced for 30 months from release date

Reference:

<https://www.windowscentral.com/whats-difference-between-quality-updates-and-feature-updates-windows-10>

Thank You For Trying MS-102 PDF Demo

To try our MS-102 Premium Files visit link below:

<https://examsland.com/latest-exam-questions/MS-102/>

Start Your MS-102 Preparation

Use Coupon **EL25 for extra 25% discount on the purchase of Practice Test Software.**